

HF-FM series

RATIO : 5.10.15 (單段 1-Stage)

入力法蘭 - 雙邊免鍵軸套

Input Flange - Double Clamping

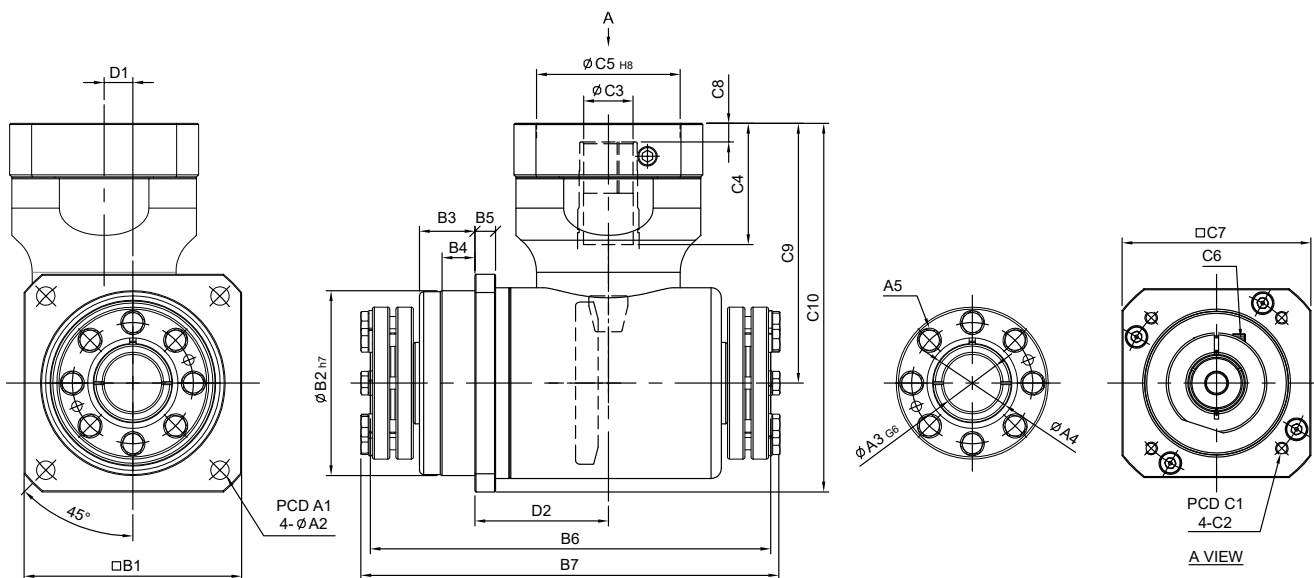

unit: mm

| | Model Code | 60 | 75 | 100 | 140 | 180 |
|-----------------|------------|--------------|--------------|----------------------|-----------------|-----------------|
| | | A | A1 | 68 | 85 | 120 |
| | A2 | 5.5 | 6.5 | 9 | 11 | 13 |
| | A3 | 15 | 20 | 28 | 40 | 55 |
| | A4 | 22 | 28 | 38 | 52 | 73 |
| | A5 | 6-M6 | 6-M6 | 8-M6 | 8-M6 | 12-M8 |
| B | B1 | 62 | 76 | 106 | 142 | 190 |
| | B2 | 60 | 70 | 90 | 130 | 160 |
| | B3 | 18 | 18 | 27 | 27 | 26 |
| | B4 | 11 | 12 | 16 | 15.5 | 15.5 |
| | B5 | 6 | 7 | 10 | 12 | 15 |
| | B6 | 144 | 155 | 195 | 253 | 311 |
| | B7 | 153 | 162 | 202 | 264 | 320 |
| C | C1 | 46 · 60 · 63 | 70 · 75 · 90 | 90 · 100 · 115 · 145 | 115 · 145 · 165 | 145 · 165 · 200 |
| | C2 | M3 · M4 · M5 | M4 · M5 · M6 | M5 · M6 · M8 | M6 · M8 · M10 | M8 · M10 · M12 |
| | C3 | 11 | 14 | 24 | 35 | 42 |
| | C4 | 26 | 33 | 59 | 82 | 84.5 |
| | C5 | 30 · 40 · 50 | 50 · 60 · 70 | 70 · 80 · 95 · 110 | 95 · 110 · 130 | 110 · 130 · 180 |
| | C6 | M4 x P0.7 | M5 x P0.8 | M6 x P1.0 | M8 x P1.25 | M10 x P1.5 |
| | C7 | 46 · 55 | 64 · 70 · 80 | 92 · 110 · 130 | 122 · 130 · 150 | 146 · 150 · 190 |
| | C8 | 5 | 6 | 9 | 10 | 10 |
| | C9 | 69 | 95.5 | 126.5 | 179 | 228 |
| | C10 | 100 | 133.5 | 179.5 | 250 | 323 |
| D | D1 | 9 | 9 | 14 | 23 | 32 |
| | D2 | 41.5 | 48 | 65 | 90 | 125 |
| Weight ±3% (kg) | | | | 5.94 | | |