

MODEL : MD42

RATIO : 20、26、44.6

用途：電動輪椅傳動軸

型式：180 度型 [大型直結式] 減速機

段數：2 段平行齒輪

Application: Transaxle for Powered Wheelchair

Specification: Parallel Shaft

Stage: 2 stage, Helical Gear

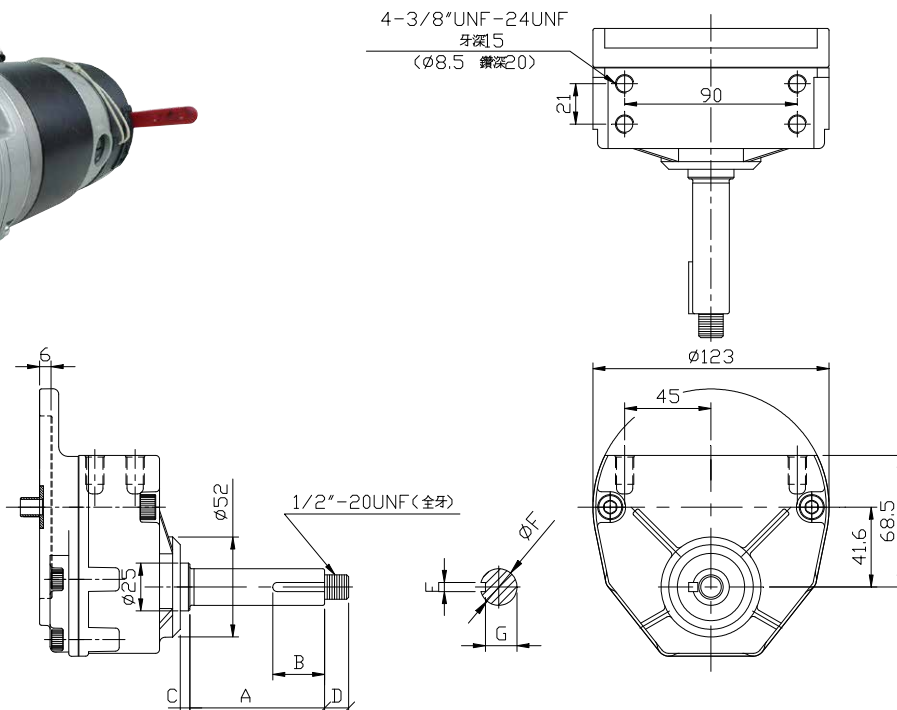

說明：參考載重 (機台重量 80kg+ 使用者載重 250kg) = 總重 ≤ 330 kg (2 台)

載重能力僅供參考，不在保證項目，請依實測為準。

Max. Loading capacity : Wheel chair 80kg+ Personnel 250kg ≤ 330 kg (2 pieces)

Load capacity is for reference only, not guaranteed items, please refer to actual measurement.

| NO | A | B | C | D | E | F | G |
|------|-----------|-----------|-----------|-----------|----------|-----------|-----------|
| 規格說明 | ≤ 60 | ≤ 55 | ≤ 20 | ≤ 20 | ≤ 8 | ≤ 20 | ≥ 16 |

| 規格 Model No. | Ratio | | | | | | |
|---|-------|--|-----------|-----------|--|--|--|
| | Unit | 20 | 26 | 44.6 | | | |
| 額定輸出扭矩 (額定 / 連續運轉) Rated Output Torque | Nm | 35 | 40 | 47 | | | |
| 最大輸出扭矩 (急停 / 瞬間啟動) Max. Output Torque | Nm | 3 倍額定輸出扭矩 3 Times of Rated Output Torque | | | | | |
| 額定輸入轉速 / Rated Input Speed | rpm | 4,000 | | | | | |
| 最大輸入轉速 / Max. Input Speed | rpm | 5,000 | | | | | |
| 馬達額定功率 (僅供參考) Motor Rated Input Power | W | 400 | 600 | 750 | | | |
| 噪音值 / Noise Level(量測距離 30cm) | dB | ≤ 63 | ≤ 63 | ≤ 60 | | | |
| 容許徑向力 / Max. Radial Force | kgf | 270 | | | | | |
| 容許軸向力 / Max. Axial Force | kgf | 135 | | | | | |
| 效率 / Efficiency | % | ≥ 90 | ≥ 88 | ≥ 85 | | | |
| 使用溫度 / Operating Temperature | °C | -15°C ~ +80°C | | | | | |
| 減速機重量 / Reducer Weight $\pm 3\%$ | Kg | 2 | | | | | |