

# VERTICAL REDUCER SERIES

## 多速比多段齒輪減速機系列

### MODEL : LSHD

臥式多速比雙軸減速機 Horizontal Multi-Stage & Double Shaft Reducer

RATIO : 1/200~1/6000

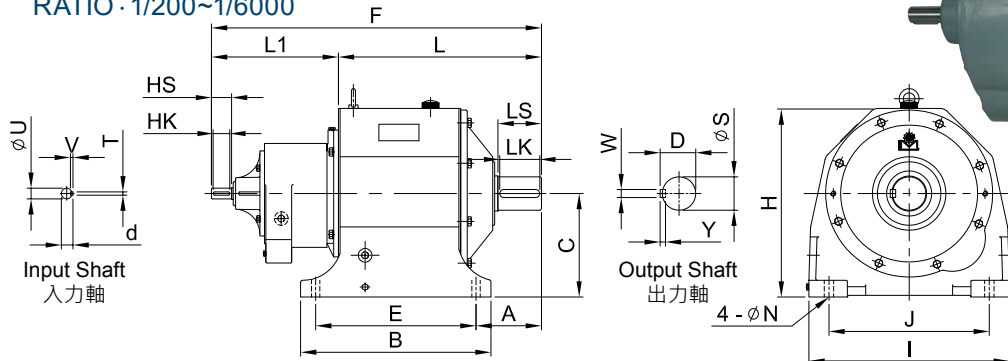

unit: mm

| 型號<br>Model | L   | L1  | F    | A   | C   | H   | 入力軸<br>Input Shaft |    |         |    | 腳座<br>Foot Stock |     |     |     |    | 出力軸<br>Output Shaft |     |       |           | 重量<br>Weight<br>(kg) | 油量<br>Oil<br>(ℓ) |  |
|-------------|-----|-----|------|-----|-----|-----|--------------------|----|---------|----|------------------|-----|-----|-----|----|---------------------|-----|-------|-----------|----------------------|------------------|--|
|             |     |     |      |     |     |     | U                  | HS | TxVxHK  | d  | E                | J   | B   | I   | N  | S                   | LS  | D     | WxYxLK    |                      |                  |  |
| 406         | 226 | 190 | 416  | 81  | 127 | 227 | 16                 | 35 | 5x5x25  | 18 | 170              | 180 | 210 | 230 | 15 | 32                  | 55  | 35    | 10x8x45   | 29                   | 1.3              |  |
| 408         | 259 | 243 | 502  | 87  | 145 | 253 | 19                 | 40 | 5x5x30  | 21 | 205              | 195 | 240 | 260 | 15 | 38                  | 60  | 41    | 10x8x50   | 41                   | 2                |  |
| 508         | 259 | 190 | 449  | 87  | 145 | 253 | 16                 | 35 | 5x5x25  | 18 | 205              | 195 | 240 | 260 | 15 | 38                  | 60  | 41    | 10x8x50   | 41                   | 2                |  |
| 410         | 283 | 292 | 575  | 92  | 164 | 289 | 24                 | 50 | 7x7x40  | 27 | 215              | 215 | 265 | 295 | 19 | 42                  | 65  | 45    | 12x8x55   | 58                   | 3                |  |
| 410S        | 273 |     | 565  |     |     | 286 |                    |    |         |    |                  |     |     | 280 |    |                     |     |       |           | 56                   |                  |  |
| 510         | 283 | 268 | 551  | 92  | 164 | 289 | 19                 | 40 | 5x5x30  | 21 | 215              | 215 | 265 | 295 | 19 | 42                  | 65  | 45    | 12x8x55   | 58                   | 3                |  |
| 510S        | 273 | 266 | 539  |     |     | 286 |                    |    |         |    |                  |     |     | 280 |    |                     |     |       |           | 56                   |                  |  |
| 610         | 306 | 215 | 521  | 92  | 164 | 289 | 16                 | 35 | 5x5x25  | 18 | 215              | 215 | 265 | 295 | 19 | 42                  | 65  | 45    | 12x8x55   | 61                   | 3                |  |
| 610S        | 296 |     | 511  |     |     | 286 |                    |    |         |    |                  |     |     | 280 |    |                     |     |       |           | 59                   |                  |  |
| 412         | 325 | 292 | 617  | 109 | 192 | 332 | 24                 | 50 | 7x7x40  | 27 | 250              | 270 | 295 | 345 | 19 | 48                  | 75  | 51    | 12x8x65   | 78                   | 4                |  |
| 412S        | 298 |     |      | 105 | 164 |     |                    |    |         |    | 215              | 215 | 265 | 295 |    |                     |     |       |           | 69                   | 3.5              |  |
| 512         | 337 | 292 | 629  | 109 | 192 | 332 | 24                 | 50 | 7x7x40  | 27 | 250              | 270 | 295 | 345 | 19 | 48                  | 75  | 51    | 12x8x65   | 83                   | 4                |  |
| 512S        | 323 |     |      | 105 | 164 |     |                    |    |         |    | 215              | 215 | 265 | 295 |    |                     |     |       |           | 74                   | 3.5              |  |
| 612         | 337 | 268 | 605  | 109 | 192 | 332 | 19                 | 40 | 5x5x30  | 21 | 250              | 270 | 295 | 345 | 19 | 48                  | 75  | 51    | 12x8x65   | 83                   | 4                |  |
| 612S        | 323 |     |      | 105 | 164 |     |                    |    |         |    | 215              | 215 | 265 | 295 |    |                     |     |       |           | 74                   | 3.5              |  |
| 414         | 390 | 329 | 719  | 130 | 210 | 385 | 28                 | 55 | 7x7x45  | 31 | 310              | 310 | 370 | 400 | 22 | 62                  | 85  | 66    | 15x10x75  | 147                  | 8                |  |
| 414S        | 387 |     |      |     |     | 377 |                    |    |         |    |                  |     |     | 390 |    |                     |     |       |           | 139                  |                  |  |
| 514         | 402 | 310 | 712  | 130 | 210 | 385 | 24                 | 50 | 7x7x40  | 27 | 310              | 310 | 370 | 400 | 22 | 62                  | 85  | 66    | 15x10x75  | 141                  | 8                |  |
| 514S        | 399 |     |      |     |     | 377 |                    |    |         |    |                  |     |     | 390 |    |                     |     |       |           | 132                  |                  |  |
| 614         | 402 | 310 | 712  | 130 | 210 | 385 | 19                 | 40 | 5x5x30  | 21 | 310              | 310 | 370 | 400 | 22 | 62                  | 85  | 66    | 15x10x75  | 145                  | 8                |  |
| 614S        | 399 |     |      |     |     | 377 | 19                 | 40 | 5x5x30  | 21 |                  |     |     | 390 |    |                     |     |       |           | 133                  |                  |  |
|             |     |     |      |     |     |     | 24                 | 50 | 7x7x40  | 27 |                  |     |     |     |    |                     |     |       |           |                      |                  |  |
|             |     |     |      |     |     |     | 24                 | 50 | 7x7x40  | 27 |                  |     |     |     |    |                     |     |       |           |                      |                  |  |
| 416         | 471 | 329 | 804  | 157 | 245 | 445 | 28                 | 55 | 7x7x45  | 31 | 360              | 360 | 430 | 450 | 25 | 76                  | 100 | 80.5  | 20x12x90  | 194                  | 12               |  |
| 516         | 492 | 329 | 817  | 157 | 245 | 445 | 28                 | 55 | 7x7x45  | 31 | 360              | 360 | 430 | 450 | 25 | 76                  | 100 | 80.5  | 20x12x90  | 212                  | 12               |  |
| 616         | 492 | 349 | 837  | 157 | 245 | 445 | 24                 | 50 | 7x7x40  | 27 | 360              | 360 | 430 | 450 | 25 | 76                  | 100 | 80.5  | 20x12x90  | 213                  | 12               |  |
| 417         | 511 | 379 | 890  | 178 | 280 | 505 | 32                 | 55 | 10x8x45 | 35 | 380              | 420 | 460 | 530 | 25 | 80                  | 110 | 84.5  | 20x12x100 | 272                  | 18               |  |
| 517         | 511 | 370 | 881  | 178 | 280 | 505 | 28                 | 55 | 7x7x45  | 31 | 380              | 420 | 460 | 530 | 25 | 80                  | 110 | 84.5  | 20x12x100 | 275                  | 18               |  |
| 517S        |     |     |      |     |     |     | 32                 | 60 | 10x8x50 | 35 |                  |     |     |     |    |                     |     |       |           |                      |                  |  |
| 617         | 526 | 353 | 879  | 178 | 280 | 505 | 28                 | 55 | 7x7x45  | 31 | 380              | 420 | 460 | 530 | 25 | 80                  | 110 | 84.5  | 20x12x100 | 266                  | 18               |  |
| 418         | 607 | 382 | 993  | 196 | 310 | 565 | 32                 | 60 | 10x8x50 | 35 | 480              | 480 | 570 | 600 | 28 | 100                 | 130 | 106.5 | 24x16x120 | 402                  | 27               |  |
| 518         | 628 | 382 | 1014 | 196 | 310 | 565 | 28                 | 55 | 7x7x45  | 31 | 480              | 480 | 570 | 600 | 28 | 100                 | 130 | 106.5 | 24x16x120 | 433                  | 27               |  |
| 518S        |     |     |      |     |     |     | 32                 | 60 | 10x8x50 | 35 |                  |     |     |     |    |                     |     |       |           |                      |                  |  |
| 618         | 628 | 370 | 998  | 196 | 310 | 565 | 28                 | 55 | 7x7x45  | 31 | 480              | 480 | 570 | 600 | 28 | 100                 | 130 | 106.5 | 24x16x120 | 436                  | 27               |  |
| 419         | 676 | 451 | 949  | 214 | 380 | 670 | 38                 | 65 | 10x8x55 | 41 | 540              | 500 | 635 | 680 | 28 | 115                 | 150 | 124   | 32x20x140 | 589                  | 37               |  |

1. 表中 S 表示新尺寸。"S" means new dimension.

2. 重量不含馬達及潤滑油。The weight does not include motor and lubricant.