

# ALUMINUM ALLOY WORM REDUCER SERIES

## 鋁合金蝸輪減速機系列

MODEL : NEOFHM

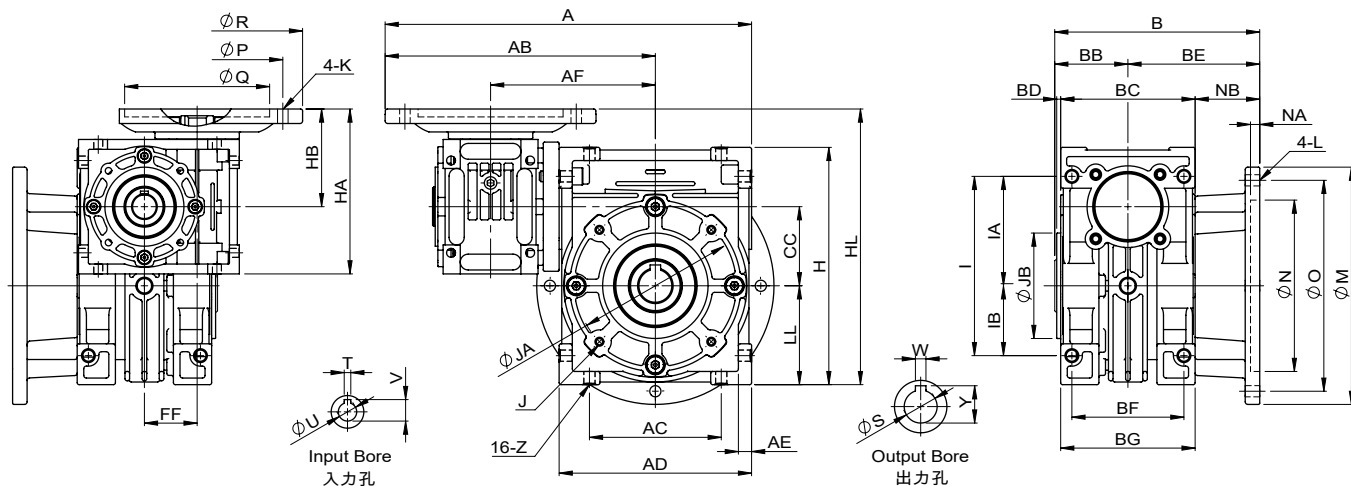

出力段減速機中心距離 (mm) Central distance of output of reducer.	40	50	60	70
入力段減速機中心距離 (mm) Central distance of input of reducer.	30	30	40	50

unit: mm

型號 Model	減速比 Ratio	馬力 HP	CC	FF	A	AB	AC	AD	AE	AF	B	BE	NB	BB	BC	BD	BF	BG	H	HA	HB	HL	I	IA	IB	LL
40	100~3600	1/8(90W) 63B	40	30	189 214	138 163	70	102	7.5	93	114	70	30	44	80	2	60	72	122	98 100	58 60	148 150	90	55	35	50
50	100~3600	1/8(90W) 63B	50	30	207 232	147 172	80	120	8.5	102	130	80	33	49	94	3	70	85	145	98 100	58 60	168 170	105	65	40	60
60	100~3600	(1/4) 1/2	60	40	278	205	100	146	10	125	154	100	49	54	102	3	85	102	180	125	74	209	136	83	53	75
70	100~3600	(1/4) 1/2 1	70	50	310 330	225 245	120	170	12	145	164	100	41	64	118	3	90	110	200	142 142 148	82 82 88	237 237 243	150	90	60	85

型號 Model	減速比 Ratio	馬力 HP	Z	馬達盤及入力孔 Motor Flange & Input Bore							出力孔 Output Bore										重量 Weight (kg)	
				P	Q	R	K	V	T	U	N	NA	O	M	L	W	S	Y	JA	JB		J×牙深 Deep
40	100~3600	1/8(90W) 63B	M8	104 115	83 95	□ 90 140	M6 M8	12.7	4	11	80	6	100	120	M8	6	20	22.8	77	60	4-M6-9	3.81
50	100~3600	1/8(90W) 63B	M10	104 115	83 95	□ 90 140	M6 M8	12.7	4	11	95	6	120	140	M10	8	25	28.3	95	70	4-M6-9	5.25
60	100~3600	(1/4) 1/2	M10	130	110	160	M8	12.7 16.3	4 5	11 14	130	7	160	180	M10	8	25	28.3	120	80	4-M8-12	9.15
70	100~3600	(1/4) 1/2 1	M10	130 165	110 130	160 200	M8 M10	12.7 21.8	4 6	11 19	150	7	185	210	M12	8	30	33.3	140	90	4-M10-15	14.68

雙段減速機以定轉速設計，最大扭力請參考「減速機參數」(第15頁)，( )為較安全選配馬力。

This 2-stage worm reducer is designed to rotate at fixed speed. We recommend to choose the HP inside ( ) for safer choice. Please refer to page I5 "Reducers Parameter."