

**MODEL : NEFHM**

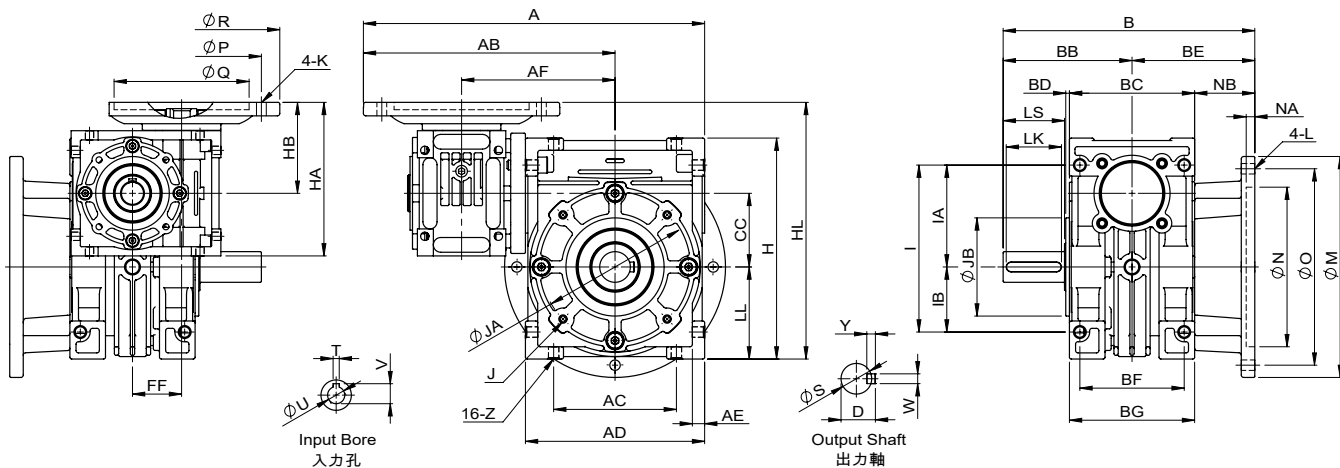

出力段減速機中心距離 (mm) Central distance of output of reducer.	40	50	60	70
入力段減速機中心距離 (mm) Central distance of input of reducer.	30	30	40	50

unit: mm

型號 Model	減速比 Ratio	馬力 HP	CC	FF	A	AB	AC	AD	AE	AF	B	BE	NB	BB	BC	BD	BF	BG	H	HA	HB	HL	I	IA	IB	LL	Z
40	100~3600	1/8(90W) 63B	40	30	189	138	70	102	7.5	93	155	70	30	85	80	2	60	72	122	98	58	148	90	55	35	50	M8
					214	163														100	60	150					
50	100~3600	1/8(90W) 63B	50	30	207	147	80	120	8.5	102	180	80	33	100	94	3	70	85	145	98	58	168	105	65	40	60	M10
					232	172														100	60	170					
60	100~3600	(1/4) 1/2	60	40	278	205	100	146	10	125	205	100	49	105	102	3	85	102	180	125	74	209	136	83	53	75	M10
					310	225														100	82	237					
70	100~3600	1/2 1	70	50	310	225	120	170	12	145	225	100	41	125	118	3	90	110	200	142	82	237	150	90	60	85	M10
					330	245														100	88	243					

型號 Model	減速比 Ratio	馬力 HP	馬達盤及入力孔 Motor Flange & Input Bore							出力法蘭及出力孔 Output Flange & Output Shaft											重量 Weight (kg)	
			P	Q	R	K	V	T	U	N	NA	O	M	L	LS	S	D	WxYxLK	JA	JB		Jx 牙深 Deep
40	100~3600	1/8(90W) 63B	104	83	□ 90	M6	12.7	4	11	80	6	100	120	M8	40	20	22.5	6x6x35	77	60	4-M6-9	4.07
			115	95	140	M8																
50	100~3600	1/8(90W) 63B	104	83	□ 90	M6	12.7	4	11	95	6	120	140	M10	50	25	28	8x7x45	95	70	4-M6-9	5.79
			115	95	140	M8																
60	100~3600	(1/4) 1/2	130	110	160	M8	12.7	4	11	130	7	160	180	M10	50	25	28	8x7x45	120	80	4-M8-12	9.7
			163	130	160	M8																
70	100~3600	1/2 1	130	110	160	M8	16.3	5	14	150	7	185	210	M12	60	30	33	8x7x55	140	90	4-M10-15	15.54
			165	130	200	M10																

雙段減速機以定轉速設計，最大扭力請參考「減速機參數」(第15頁)，( ) 為較安全選配馬力。

This 2-stage worm reducer is designed to rotate at fixed speed. We recommend to choose the HP inside ( ) for safer choice. Please refer to page 15 "Reducers Parameter."